

#4 Tahoe Bldg

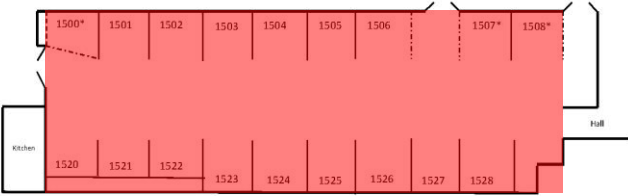

Auburn Home Show Availability Maps & Pricing

Spring: May 14-16, 2021

Updated: 5/3/21



#16 Placer Building

Red square = Booked

Blue square = Pending

Grey square = No Longer Used



#5 Sierra Building Includes basic electricity * = No pipe, drape or electricity

500 watts electrical included in all indoor excluding foyers, harvest fest & concessions.



#10 Armory Building

#18 Courtyard Pavilion



Pricing

Indoor:
 8x10 - \$900, \$1,000 corner
 10x10 - \$950, \$1050 corner

Tahoe Bldg:
 10x9 1/2 - \$935 (1507, 1508)

Armory Bldg:
 10x15: 23 - \$1,375
 20x13: 9 - \$1,600
 23x13: 64 - \$2,150

G & G Bldg:
 8x10 - \$350, Corner \$400
 8x15: *717 & *706 - \$500

Placer Bldg:
 #201: 10x20x6 - \$600
 #205: 13x17 - \$1,450
 #216: 15x17 - \$1,700

Sierra Bldg:
 8x8: 306 & 316 = \$950
 5x10: *333 & *334 = \$550
 8x20: 317 = \$1670
 10x20: 308 = \$1700
 10x16: 311 = \$1320

~Multiple Indoor Booth Discount~
 - 2+ = 10%
 - 4+ = 15%

Miners Bldg: Not Pictured - Call for details

All Purchases Include a 3.5% Convenience Fee, however, we offer a discount for cash/check payments and all booth pricing listed represents the cash discount.

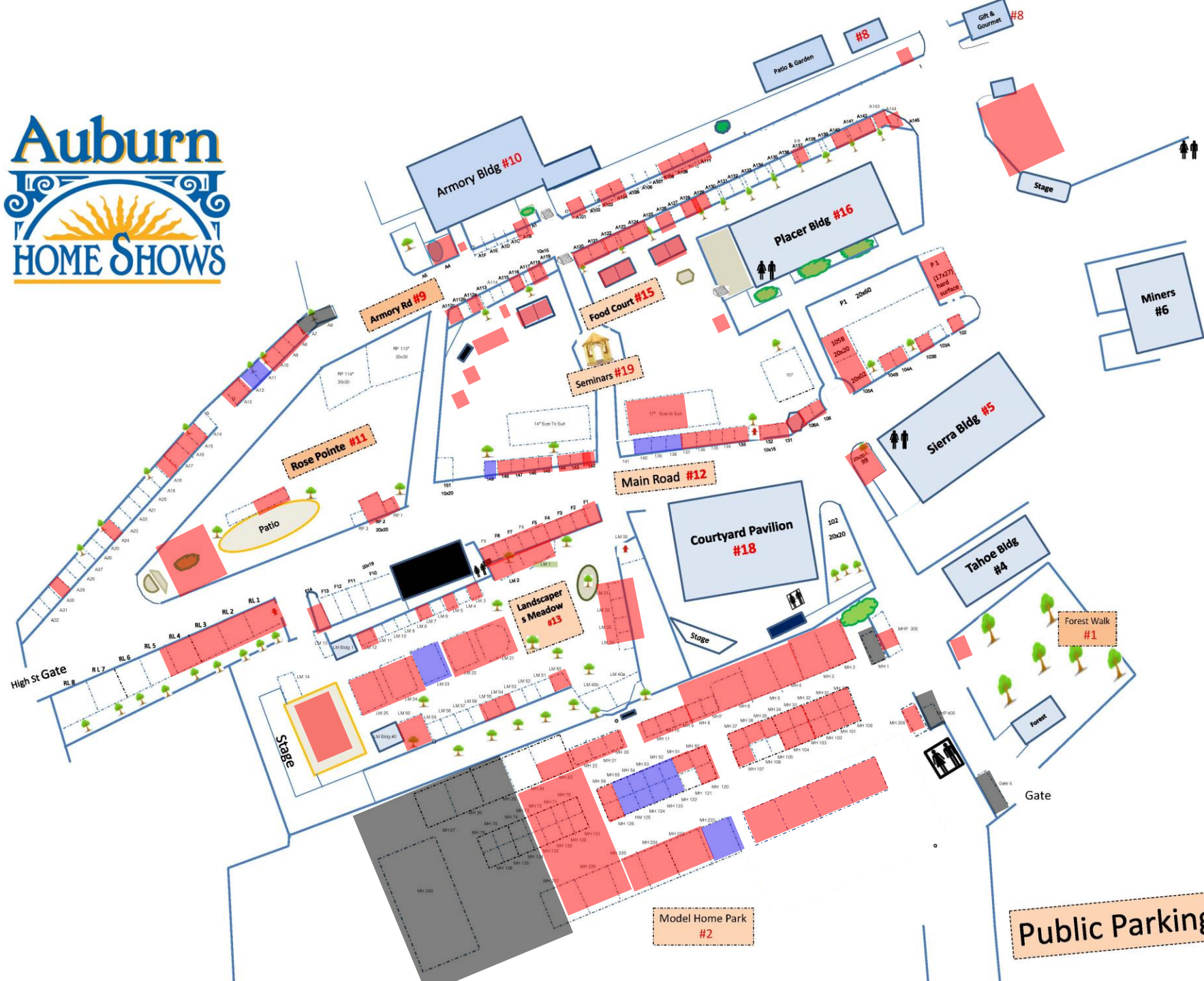

Outdoor:

Model Home Park – 10x10's - \$550, \$600 corner
 Mh30 & MH100 \$650, 20x20's - \$1,250
 20x30's - \$1,600, 30x30 - \$2,100

Landscapers Meadow – 10x10's - \$550, \$600 corner
 10x20's - \$925, 20x20's - \$1,250
 20x30's - \$1,600

Main Rd – 10x10's - \$650, \$700 corner
 20x20's - \$1,250, 20x30's - \$1,600, 30x30 - \$2,100,

Armory Rd – 10x10's - \$550, \$600 corner
 10x15's - \$825,

Lower Armory Rd.
 \$350 (non-G&G companies)
 \$300, \$350 corner (Gift & Gourmet)

Red Barn - \$600

~Multiple Outdoor Booth Discount
 (excluding Lower Armory Rd.)~
 - 3+ = 10%
 - 5+ = 15%

All Purchases Include a 3.5% Convenience Fee, however, we offer a discount for cash/check payments and all booth pricing listed represents the cash discount.